

# LUX ELEMENTS<sup>®</sup>-TEC-VWD

## Instruction for assembly

07 | 2013 · We reserve the right to make technical changes.

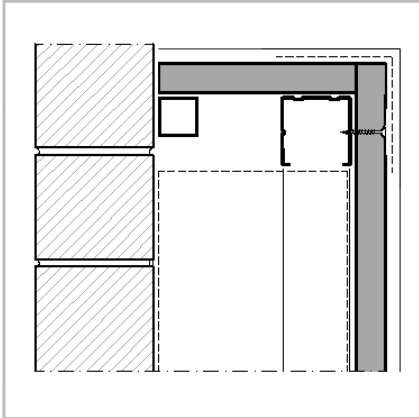

### ■ LUX ELEMENTS<sup>®</sup>-TEC-VWD

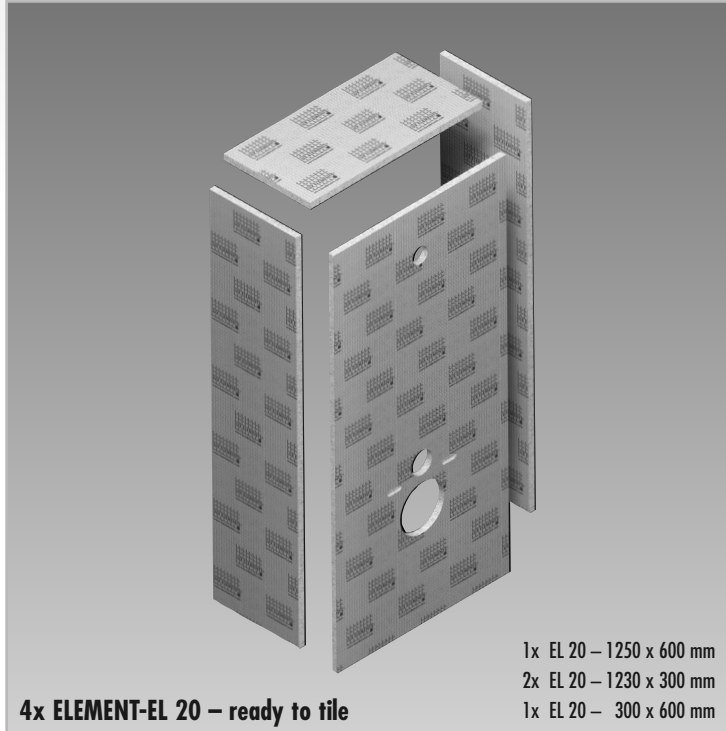

### ■ KIT



### NOTE

When planking with wall mounted system elements, the information issued by the respective manufacturer must be taken into consideration.

### ■ THE MOST IMPORTANT TOOLS

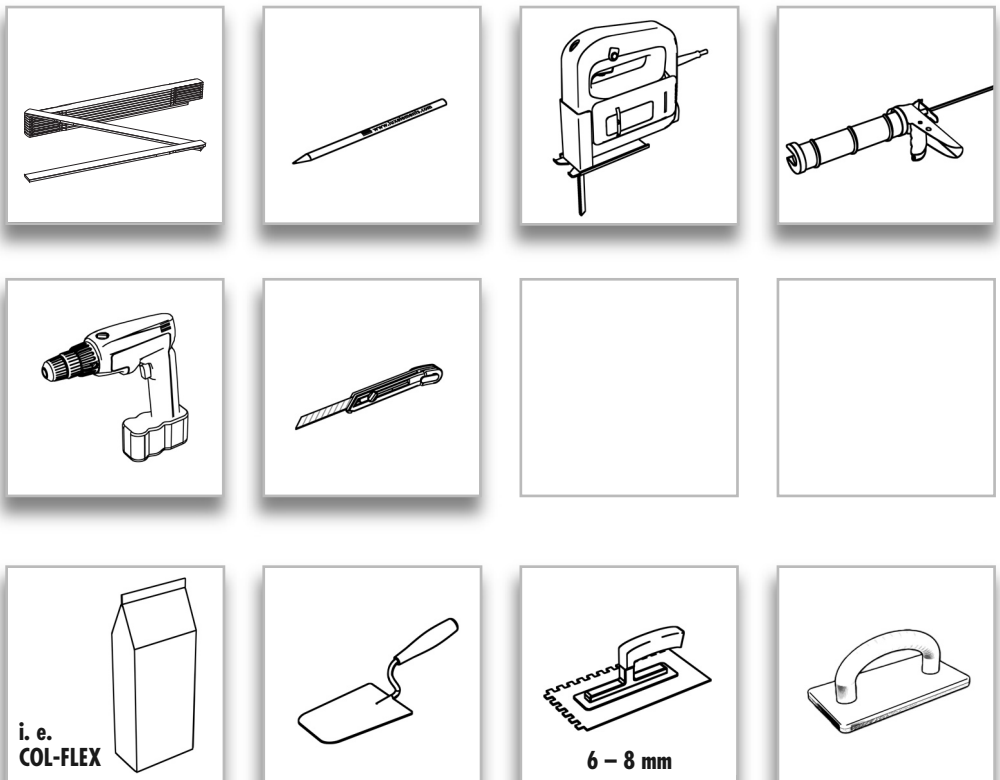

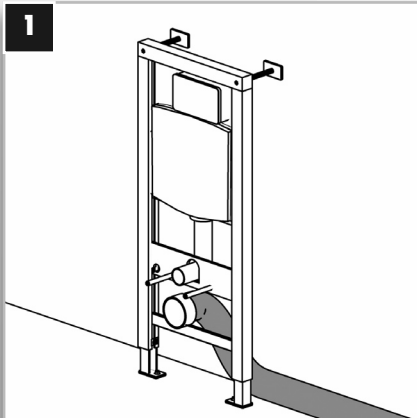
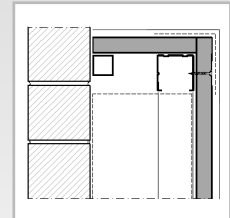

The wall-mounted construction forms the sub-construction. When planking with wall-mounted system elements, the information issued by the respective manufacturer must be taken into consideration.

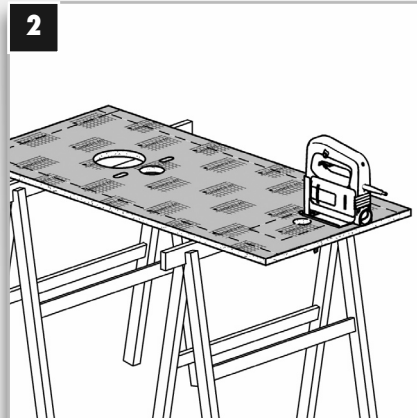

The ELEMANT construction panels including the notch for the subsequent assembly of the push plate are cut to size.

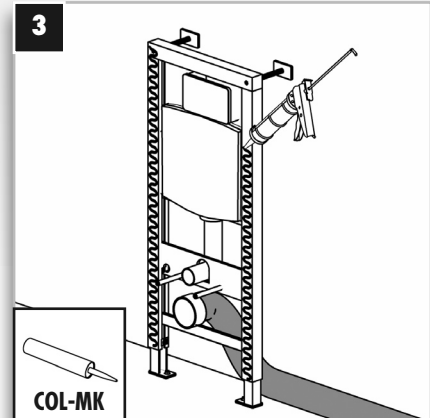

Apply COL-MK on both the support structure as well as on the ELEMANT construction panels. We recommend a snake-shaped application of cartridge adhesives.

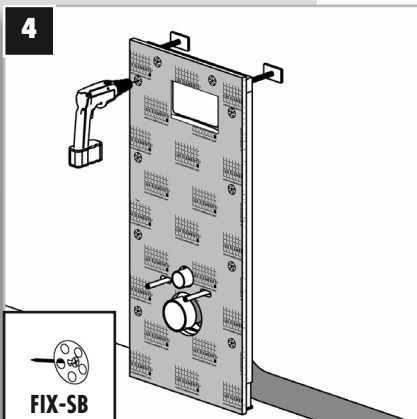

Screw with the fastening kit FIX-SB 45S35. Observe the wall-mounted element manufacturer's recommendation as to spacing.

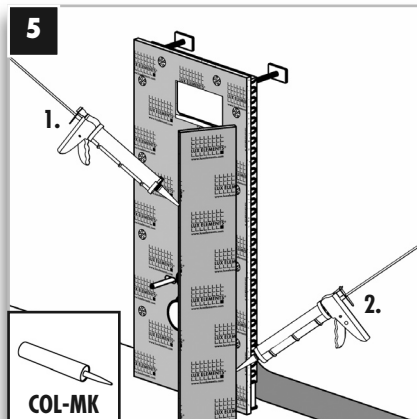

The ELEMANT construction panels are glued together with COL-MK. Apply the adhesive to the plate edges as an uninterrupted strand. As soon as the front panel has been mounted ...

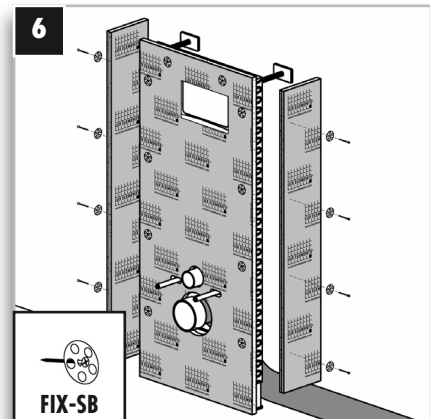

... proceed in the same way with the two side panels. After bonding with the construction and the wall screw tight using FIX-SB 45S35.

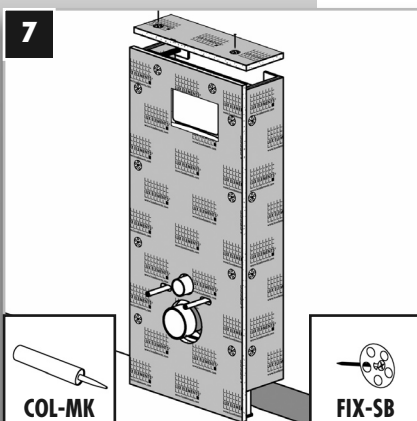

Finally also mount the top cover as described previously.

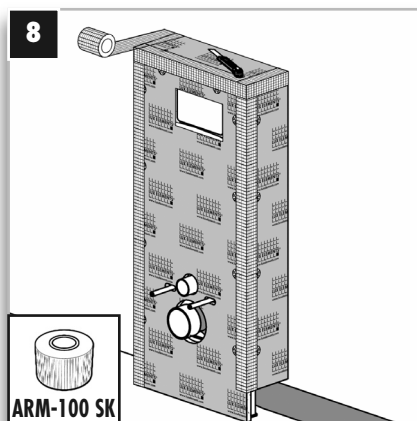

Reinforce all element joints and transitions with glass fibre reinforcement strips ARM-100 SK.

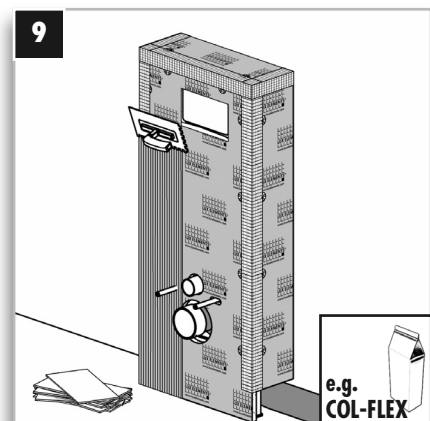

The surface is now ready for tiling. Further requirements (e.g. sealing) must be taken into consideration in accordance with national directives.